

PORTERVILLE

Tourist & Property information www.porterwil.co.za



Porterville is a town situated in the Western Cape province of South Africa. The distance from Cape Town to Porterville is about 140 km.

Porterville is also home to some of the best campsites in the Cape; Waterfalls and Beaverlac. Laatson offers self catering chalets, conference facilities and is also a wedding venue.

The town rests at the foot of the Olifants River Mountains, 27 km south-east of Piketberg. It was laid out in 1863 on the farm Pomona, previously Willems Vallei, and became a municipality in 1903. It is situated 140 km north of Cape Town on the R44 road at the base of the Olifants River mountains. Agriculture in the area is dominated by wheat production.

This unspoilt country town of some 9 000 inhabitants is a land of extremes, offering diversity, hospitality and authenticity. The region is famous for the rarest of flowers, the Disa Uniflora. It is the only place in South Africa where one can see fields of these flowers in nature, the rarest being the sulphur yellow Disa, which has been found only in one small colony in Porterville.

Climatic conditions vary from dry, hot summers with powerful thermals (making it the ideal location for paragliding enthusiasts) followed by severe winters, with snow on the mountain peaks and storms rolling in from the Atlantic coast in the west. The Dasklip Pass takes one to the mountain and the Groot Winterhoek Nature Reserve.

Hiking trails, to places called Die Hel and De Tronk, reveal dramatic rock formations and an abundance of flora and fauna. Die Hel has one of the largest rock pools in South Africa. The Waterfall Trail leads where waterfalls plummet down towards undulating wheat fields. Also to be enjoyed is the Tulbagh Cellars with their own unique, organically produced wines.

Accommodation in Porterville

NOTE: Visit www.porterwil.co.za and follow the links to the websites and e-mail addresses.



In Town:

Akkediskis - 083 564 3018
De Herberg Guest House - 022 931 3187
Flyers' Lodge - 022 931 3416
Isabella's Self Catering - 082 564 4749
Mayor's Manor - 082 551 3460
Mountain View Guest House - 022 931 2626
Porterville Hotel - 022 931 2178
Rendezvous Guest House - 022 931 3484
Swallows Rest Guesthouse - 061 164 9193
Talani - 082 921 8316
The Stable - 084 049 5757
Twin Trees Guest House - 082 304 6868
Villa Cho-co-latt - 022 931 3877

Out of Town:

Exelsior Guest Farm - 082 380 0946
Die Koejawelhuisie - 083 955 4081
Die Uil Huisie - 022 931 2534
Laatson Functions & Chalets - 082 601 0869 / 082 304 6868
Lekker Water - 072 600 5685
Waterfalls Holiday Farm - 082 878 1358
Mooi Berg Plaas - 083 542 7700
Peace of Africa - 083 656 5292

On the Mountain:

Beaverlac Camping & Cottages - 022 931 2945
Berghoff Fynbos Farm Chalets - 022 931 2937
Cedar Peak Cottages - 021 424 8096
Groot Winterhoek Mountain Conservancy - 022 931 2860
Pampoenfontein Farm Cottages - 082 564 5500



Things to do in Porterville

NOTE: Visit www.porterwil.co.za and follow the links to the websites and e-mail addresses.

Gym - Forbes Fitness - 022 931 2138 or 081 270 8993 - Main Road Porterville.

Tennis - Setiaan Visser - 083 959 7638 - Tennis Courts just off Park Street.

Golf - Golf Club go down Malan street - 022 931 2017.

Ponie rides / Tractor rides at the Farmer's Market - 084 049 5757.

Lawn Bowling - Willem Odendaal - 071 870 1035 - behind tennis courts just off Park Street.

Mountain Biking at Waterfalls Campsite - 082 878 1358.

Hiking up the mountain past the 23 Waterfalls or hiking along mountain bike routes - at Waterfalls Campsite - 082 878 1358.

Karate - JKA Karate - 022 931 2138 or 081 270 8993.

Paragliding & Hang-gliding - shuttle service for flyers to Dasklip Pass - Flyer's Lodge - 022 931 3416.

Outrides on Horseback - book an outride with Julia Valentine - 083 702 3576.

Enjoy the View - Drive up Dasklip Pass and enjoy the view and watch Paragliders and hang-gliders launch.

Farm Animals - at Waterfalls Campsite - 082 878 1358.

Jan Danckaert Museum - corner of Mark and Du Toit street - 022 931 3528.

Micro Greens - 14a Rose street - Steve 022 931 3209.

Jewelry Making workshops at EbonyMoon - Du Toit street - 084 531 4506.

Local Artists visit them by appointment - List available at www.porterwil.co.za under Information.

Craft Beer at Indie Ale - on the way to Gouda - 022 125 0187.

Bird watching The endangered blue crane are often spotted in large numbers. If you're lucky you may spot a pair doing their elaborate courting dance routine. Keep a look out for these gracious birds who frequent the wheat fields surrounding the town. Regular sightings of the booted and Verreux's Eagle are recorded on the mountain.

Rock Art Originally the region was inhabited by the San (Bushmen) centuries before the arrival of the Dutch Settlers and the mountains in the region contain numerous rock art sites. Rock art is protected by the National Monuments Act (1969) and vandals who deface rock paintings face high fines. Therefore most of the sites, now located on private land, are not open to the public. Examples of some of the rock art is on exhibit in the Jan Danckaert Museum in town. For the more energetic, as reaching these sites often include strenuous activity, the Groot Winterhoek Wilderness area offers some remarkable examples of San and Khoi rock art. These paintings, found in rocky overhangs and caves, vary between 300 and 6 000 years. Beaverlac also has several caves on the farm, some of which are decorated with paintings. Access to these are only permitted if accompanied by a guide.

Fishing - Bass fishing at Waterfalls Campsite - 082 878 1358.

Visit the **Porterville Tourism** website - for more activity ideas in and around Porterville - www.portervilletourism.co.za

Porterville's weekly Farmer's Market (Every Saturday 9am - 2pm)

Porterville's weekly farmer's market sells outstanding, locally sourced fresh produce including products such as homemade butter, raw milk, meat, home grown vegetables, natural preserves and much more. Situated on the farm, Houdconstant, bordering the town of Porterville, the market offers a relaxed deli atmosphere where one can feast on handcrafted breakfasts from the Food Bar, pancakes from the Pancake Bar or sip a freshly made cup of coffee. While enjoying a morning of relaxed shopping the kids can have fun on a tractor ride around the farm, a horse ride or simply spend time digging in the sandpit.

Drive past the Porterville High School and take the first dirt road to your right to capture a Saturday country moment under the Houdconstant trees.

Give Phil a call on 084 049 5757 to find out more.



Food & Drink

NOTE: Visit www.porterwil.co.za and follow the links to the websites and e-mail addresses.

Restaurants & Food

Akkediskis (Pub & Eat) - corner Voortrekker Street (Main Road) & Basson street
083 564 3018

Farmer's Market Porterville (Every Saturday 9am - 2pm) - Houdconstant Farm
084 049 5757

Flyer's Lodge (Pub & Eat) - 87 Voortrekker Street (Main Road)
022 931 34156

Indie Ale (Hand Crafted Beer & Pizza) - 15 km outside Porterville towards Gouda
022 125 0187 (Wed to Sat)

Koppikofi (Restaurant) - corner Voortrekker Street (Main Road) & Basson Street
022 931 3877

Kwagga's (Pub, Eat & Take Away) - 19 Church Street (corner Main Road)
078 863 8927

Long Table at The Stable (Eating Experience) - 17 Frank Street
084 049 5757 - weekly by booking

Ocean Wonders Fish & Chips (Take Away) - Voortrekker Street (Main Road)
072 471 6748

Porterville Hotel (Restaurant & Pub) - 18 Voortrekker Street (Main Road)
022 931 2178

Rendezvous (Restaurant & Pub) - 36 Voortrekker Street
022 931 3484

Pubs & Bars

Friendz (Pub & Eat) - corner Voortrekker Street (Main Road) & Basson street
083 564 3018

Flyer's Lodge (Pub & Eat) - 87 Voortrekker Street (Main Road)
022 931 34156

Indie Ale (Hand Crafted Beer & Pizza) - 15 km outside Porterville towards Gouda
022 125 0187 (Wed to Sat)

Kwagga's (Pub, Eat & Take Away) - 19 Church Street (corner Main Road)
078 863 8927

Porterville Hotel (Restaurant & Pub) - 18 Voortrekker Street (Main Road)
022 931 2178

Rendezvous (Restaurant & Pub) - 36 Voortrekker Street
022 931 3484



Telephone Numbers

Agrisell - 081 429 9197 / 021 224 0899

ABSA - 022 931 2117

Agrimark - 022 931 8300

Blinds & Carpets - 083 233 7929

Breedenet (Wireless Internet) - 083 630 8217

Builder & Technical Drawings - 083 283 5429

Cape Nature - 022 931 2900

Chemist - 022 931 2121

Cruywagen Carpentry - 022 931 3181

Danie Gouws (Insurance) - 022 931 2554

De Villiers - Van Zyl (Attorneys) - 022 931 2596

Hi-Q (Tyres & Exhausts) - 022 931 2105

High School Porterville - 022 931 2174

Keys Cut (Jack's Piketberg) - 082 551 1707

Laubscher's Garage - 022 931 2181

Louw & Cronje (CA) - 022 931 2110

Nell (Doctor) - 022 931 2155

OK Grocers - 022 931 2061

Oranje Slagtery - 022 931 2380

Overberg Agri - 022 931 8620

Post Office - 022 931 2583

SkipGo (Building, Garden Refuse, Stone, Sand) - 083 265 8112

SPAR - 022 931 2150

The Pen and Paper Den - 022 931 2163

Trusc (Wireless Internet) - 087 020 0000

Tyre & Exhaust - 022 931 3314

U-Save - 022 931 2621

Vetinary service - 022 931 2123

Wilbo (car parts) - 022 931 3477

Porterville Municipality

Porterville falls under the Bergriver Municipality in the Western Cape. The municipal offices can be found in Mark street, Porterville or phone them on 022 931 2100.

Porterville Municipality office hours:

Mo - Thu: 7h30 - 16h30 (closed for lunch 13h00 - 13h45)

Fri: 7h30 - 15h30 (closed for lunch 13h00 - 14h00)

Porterville Municipality office hours for payments:

Mo - Fri: 7h30 - 15h00 (not closed for lunch)

Emergency Numbers

Ambulance - 022 931 2601

Police - 022 931 8700

Hospital - 022 931 2140

Municipality - 022 931 2100

Chemist / Clinic - 022 931 2121

Fire Brigade - 022 913 3315 / 6

Fire / Disaster - 10177

Fire / Disaster - 083 272 3714

Traffic / Law (after hours) - 083 272 4126

Electrical - 083 272 3294

General Emergency - 083 272 3853

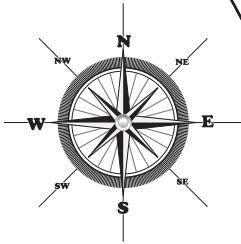

PORTERVILLE ERF MAP

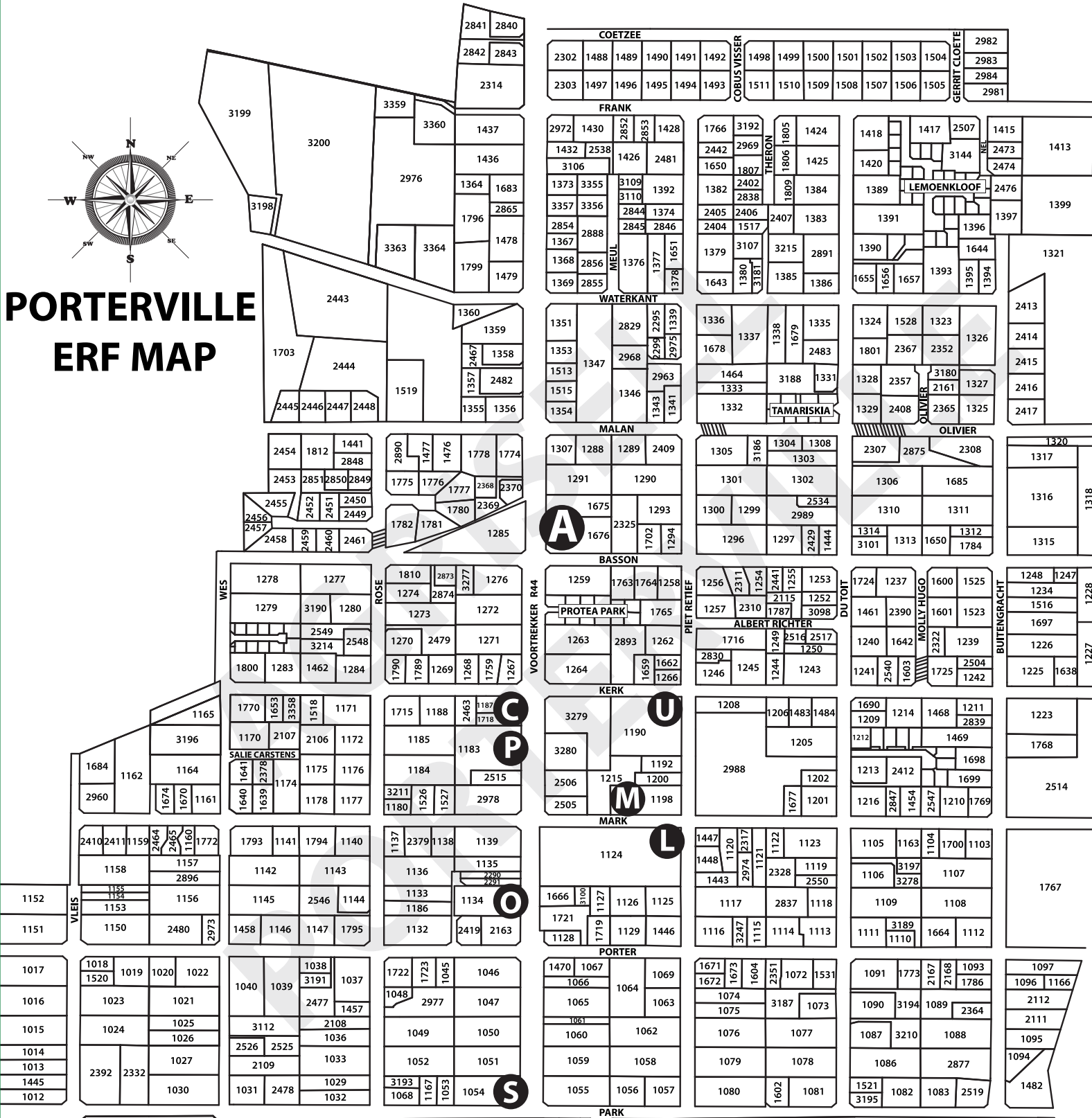

- M** - Municipal Office **U** - NG Church **S** - Spar
- P** - Police **L** - Library - Road Blocked **A** - Agrisell Office
- C** - Chemist **O** - OK **PROTEA PARK** - Estate / Development

This Map is not to scale or its correctness guaranteed. Map supplied & Copyrighted by Agrisell, Porterville.

www.agrisell.co.za
www.porterwil.co.za

Agrisell Office, 48 Voortrekker Road (corner Basson st), Porterville

